

■ 内接头 (PN软管安装式)

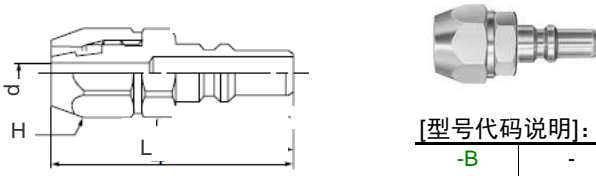

[型号代码说明]:

-B	-
黄铜 (镀铬)	-

型号选择		适用软管 内径×外径	L (mm)	d (mm)	H (mm)
型号	可选代码				
QMS-40PN	-B	4×6	31	2.5	六角10
QMS-45PN	-B	4.5×6	31	3	六角10

■ 外接头 (SN软管安装式)

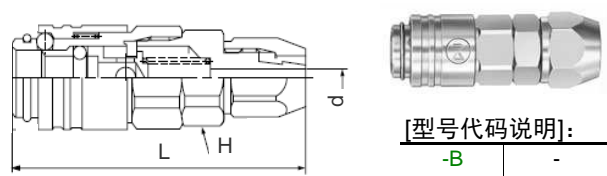

[型号代码说明]:

-B	-
黄铜 (镀铬)	-

型号选择		适用软管 内径×外径	L (mm)	d (mm)	H (mm)
型号	可选代码				
QMS-40SN	-B	4×6	40.8	2.5	六角12
QMS-45SN	-B	4.5×6	40.8	3	六角12

■ 内接头 (PM外螺纹安装式)

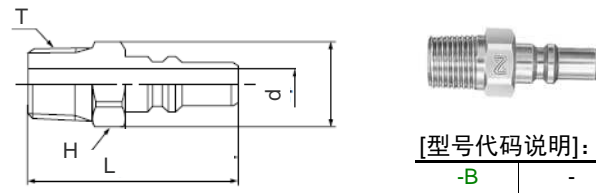

[型号代码说明]:

-B	-
黄铜 (镀铬)	-

型号选择		螺纹T PT(R)	L (mm)	d (mm)	H (mm)
型号	可选代码				
QMS-10PM	-B	R1/8	28.5	4	六角11
QMS-20PM	-B	R1/4	32.5	4	六角14

■ 外接头 (SM外螺纹安装式)

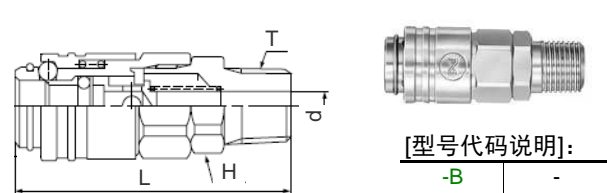

[型号代码说明]:

-B	-
黄铜 (镀铬)	-

型号选择		螺纹T PT(R)	L (mm)	d (mm)	H (mm)
型号	可选代码				
QMS-10SM	-B	R1/8	36.8	4	六角12
QMS-20SM	-B	R1/4	40.8	4	六角14

■ 内接头 (PF内螺纹安装式)

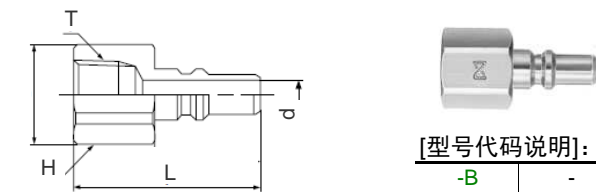

[型号代码说明]:

-B	-
黄铜 (镀铬)	-

型号选择		螺纹T PT(Rc)	L (mm)	d (mm)	H (mm)
型号	可选代码				
QMS-10PF	-B	Rc1/8	27	4	六角13

■ 外接头 (SF内螺纹安装式)

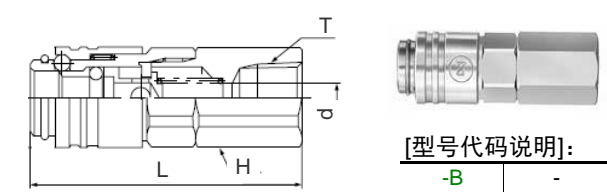

[型号代码说明]:

-B	-
黄铜 (镀铬)	-

型号选择		螺纹T PT(Rc)	L (mm)	d (mm)	H (mm)
型号	可选代码				
QMS-10SF	-B	Rc1/8	38.8	4	六角13

■ 内接头 (PC软管安装式)

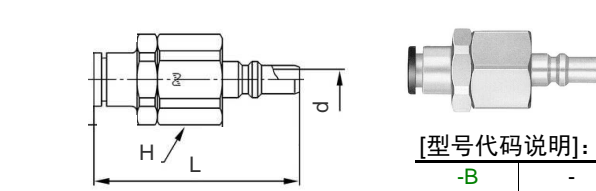

[型号代码说明]:

-B	-
黄铜 (镀铬)	-

型号选择		适用软管 外径(mm)	L (mm)	d (mm)	H (mm)
型号	可选代码				
QMS-20PC-6	-B	6	40.5	4	六角16
QMS-20PC-8	-B	8	47.5	4	六角16

■ 外接头 (SC软管安装式)

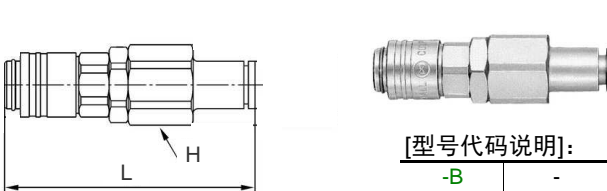

[型号代码说明]:

-B	-
黄铜 (镀铬)	-

型号选择		适用软管 外径(mm)	L (mm)	H (mm)
型号	可选代码			
QMS-20SC-6	-B	6	56.3	六角16
QMS-20SC-8	-B	8	60.8	六角16